

Butia 

General Catalogue

uPVC Profile,
Insulating Glass

Edition 13

Mr.Dariush Tahmasebi's message	5
Butia Industry Complex	8
Certificates	10
uPVC Door & Window Profile	12
Profile Section Detail	18
Laminated and color design	28
Double- and triple-glazed glass	36
Decorative glass	42
Butia Laboratory	56



Message of the Founder

The rich resources of our country, not only cater for the needs of our nation, but can meet the demands of many other countries as well.

The construction sector with about 35% share of energy consumption should work towards making the necessary policies. It is our duty to think and act with foresight to reduce energy losses.

Our Goals are:

- Rendering services in line with national interests.
- Advancing and elevating the level of construction industry.
- Creating jobs for the young generation.
- Optimizing energy use.

These objectives made us to establish Butia Industry Complex with the purpose of producing uPVC profiles for manufacture of doors and windows.

This is a policy we thought as our share in solving the problem of energy loss.

We hope the industries in other fields would pay attention to this important issue as well.

We believe in:

- Customer's right to more choices.
- Customer's right to be more comfortable.
- Customer's right to live in better style.
- Customer's right to have the best quality.



Butia 



Butia Industry Complex

As the first uPVC manufacturer in Iran, Butia Industry Complex was founded in September 2002 with the aim of enhancing the quality of construction industry, realizing the internal policies on fuel consumption optimization, preventing the loss of national capitals, and reducing the household expenses. Factories of this complex cover an area of 11 hectares and a built-up area of 25,000 m² in the Industrial Park No.2, Kerman. They performed a trial run in June 2005, and initiated their commercial production in 2006.

In the first phase of the plan, the complex incorporated the deployment of advanced production lines and machineries, with an annual production capacity of 9000 t different uPVC profiles to build casement and sliding doors and windows, 150,000 m² double-glazed glasses, and 100,000 m² uPVC doors and windows. To accomplish the Butia Industry Complex founder's high-level goals, the second and third phases continue to operate until a production rate of 100,000 t/year profiles is achieved.



Certificates

- BHRC CERTIFICATE for uPVC profile
- BHRC CERTIFICATE for Double glazing glass
- BHRC CERTIFICATE for uPVC Window
- ISO/IEC 17025
- ISO 14001: 2015
- OHSAS 18001: 2007
- ISO 9001: 2015
- Kerman top production Company 2011, 2012, 2013, 2014
- Iran top production Company 2013



uPVC Door & Window Profile



uPVC Profile:

Production of uPVC doors and windows was started in Europe in 1960, and today are widely used all over the world. Double pane windows are a perfect insulation against loss of energy, sound and dust. Also, such windows have the advantage of energy saving as well as lowering energy consumption costs. In addition using uPVC windows would require much lower capacity heating and cooling systems, and hence lower utility equipment costs of the building.

At Butia we have an absolute commitment to ensuring that each and every one of the creations we produce provides our end users with exceptional advantages over those of our competitors. Because we have been able to design our range from scratch rather than attempting to improve out-of-date systems, we have been able to consider and factor in future legislation and industry guide-lines. We set our stall out to cut out unnecessary costs and to provide products that are easy to manufacture, easy to install and to include a whole host of benefits and features for the end users. This is why we firmly believe that our products are the best on the market.



A-Class Profile

Butia's A-class door and window uPVC profiles, with the latest global standards, can be used to manufacture uPVC doors and windows in different models and colors, customizable by designers and architects, with a wide variety of sections. Butia's profiles with 34 sections are used to manufacture different kinds of casement and sliding windows. The company offers hundreds of models and colors using various laminates, uPVC colors, and aluminum coatings for doors and windows.



Profile Section Detail



Door Sash
Art.No.: TD4
Weight: 1660 gr/m

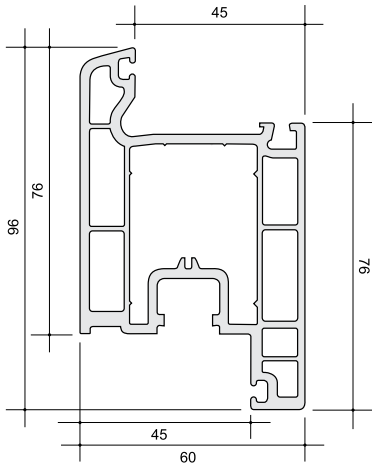

Outside Opening Door Sash
Art.No.: TM3
Weight: 1670 gr/m

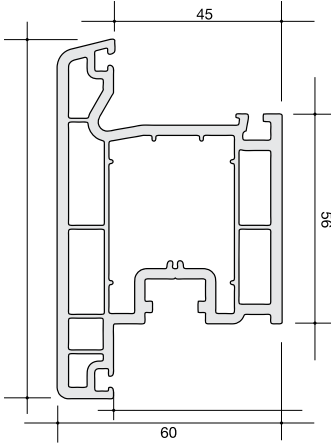

Mullion
Art.No.: TD3
Weight: 1420 gr/m

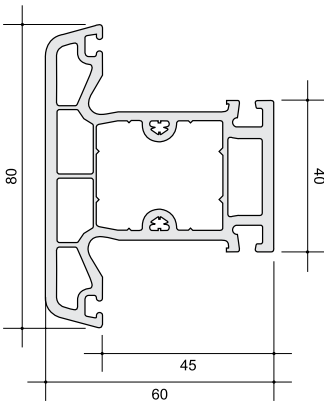

Mullion 2
Art.No.: TM7
Weight: 1340 gr/m

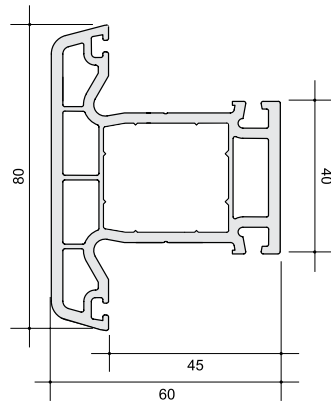

Overhung
Art.No.: TD5
Weight: 900 gr/m

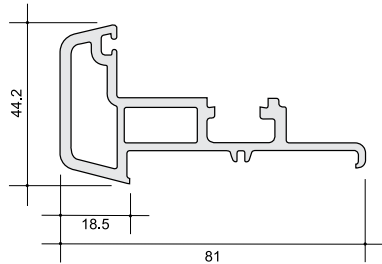

Overhung 64
Art.No.: TM4
Weight: 1130 gr/m

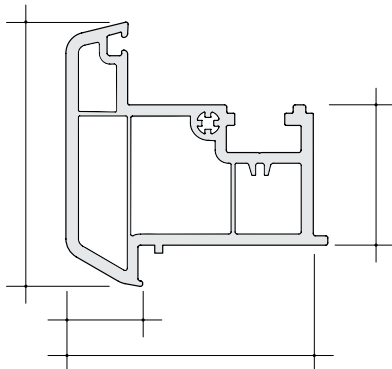

Frame
Art.No.: TD1
Weight: 1300 gr/m

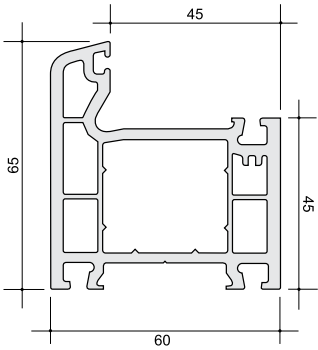

Renovation Frame
Art.No.: TM1
Weight: 1310 gr/m

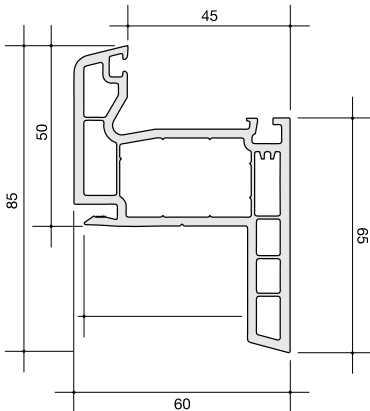

Renovation Frame Cover 68x38
Art.No.: TM2
Weight: 470 gr/m

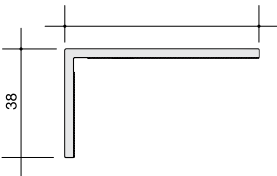

Window Sash
Art.No.: TD2
Weight: 1400 gr/m

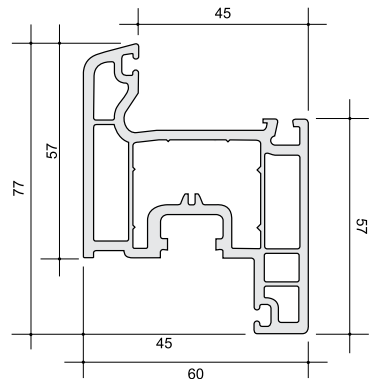

Door Sash 35
Art.No.: TM9
Weight: 1820 gr/m

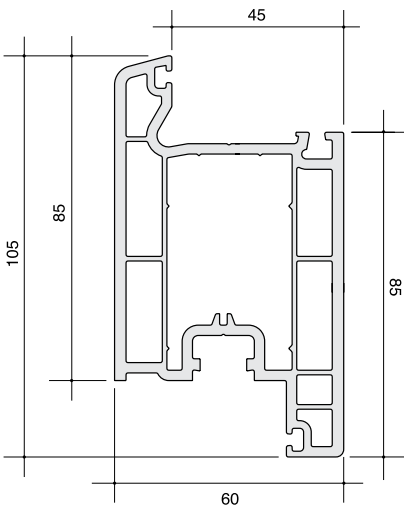

Butia Series

Tilt & Turn Systems

Slider Window Sash

Art.No.: TD9
Weight: 1270 gr/m

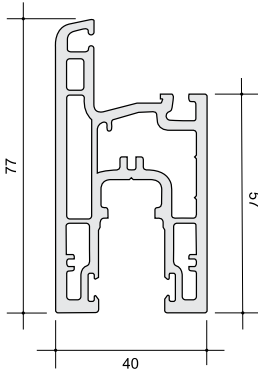

Slider Door Sash

Art.No.: TE0
Weight: 1460 gr/m

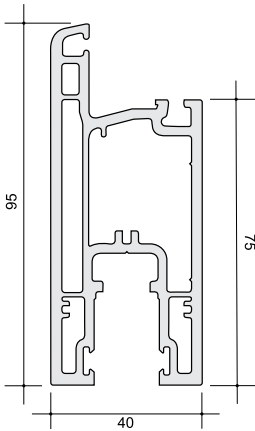

Interlock Window Sash

Art.No.: TE1
Weight: 300 gr/m

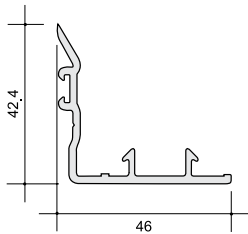

Interlock Door Sash

Art.No.: TE2
Weight: 330 gr/m

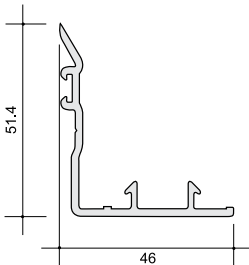

Slider Sash Connector

Art.No.: TE4
Weight: 240 gr/m

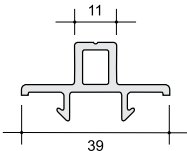

Mosquito Sash

Art.No.: TE9
Weight: 490 gr/m

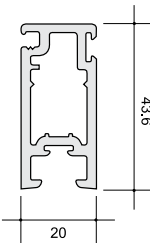

Slider Frame

Art.No.: TD6
Weight: 1320 gr/m

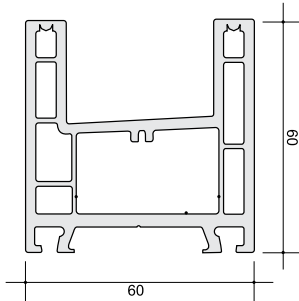

Fixed Slider Frame

Art.No.: TD7
Weight: 1470 gr/m

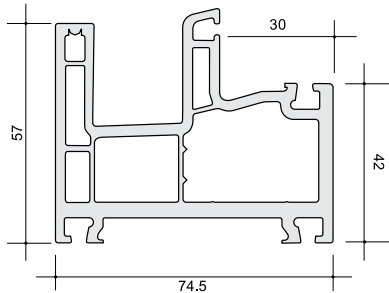

Fixed Slider Frame 2

Art.No.: TM5
Weight: 1570 gr/m

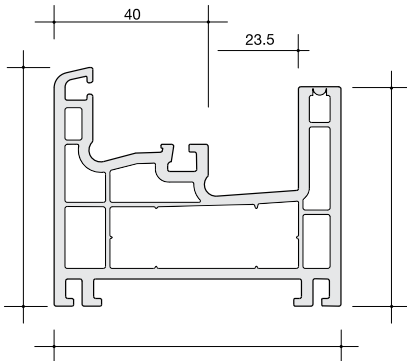

Cover Fixed Slider Frame

Art.No.: TE3
Weight: 210 gr/m

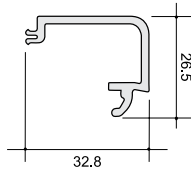

Slider Frame Triple Track

Art.No.: TD8
Weight: 1740 gr/m

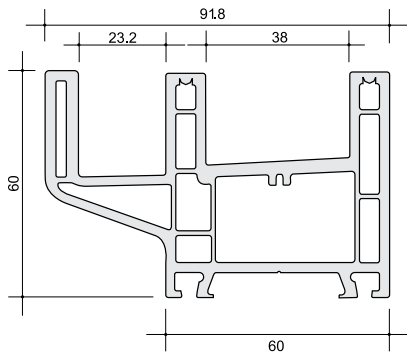

Butia Series

Sliding
Systems

Butia Series

Auxiliaries

Coupling
Art.No.: TE5
Weight: 300 gr/m



Static Couplimng
Art.No.: TF1
Weight: 1400 gr/m

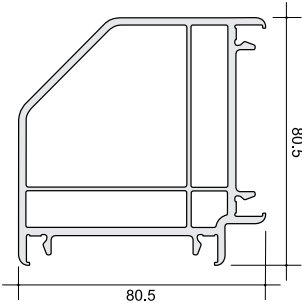

Glazing Bead 7mm
Art.No.: TE7
Weight: 160 gr/m



Pipe
Art.No.: TF2
Weight: 900 gr/m

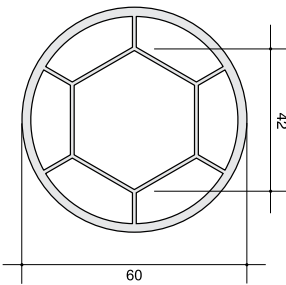

Pipe Adaptor
Art.No.: TF3
Weight: 600 gr/m

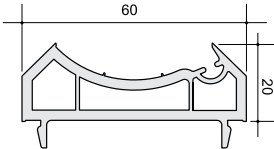

Glazing Bead 16mm
Art.No.: TM6
Weight: 200 gr/m

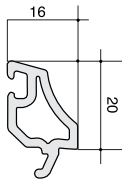

Glazing Bead 18mm
Art.No.: TE8
Weight: 200 gr/m

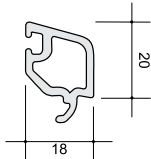

Angle Section 40x50
Art.No.: TF4
Weight: 380 gr/m

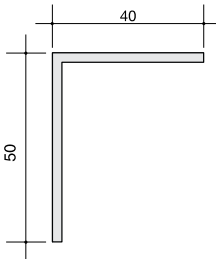

Frame Extention
Art.No.: TM8
Weight: 290 gr/m

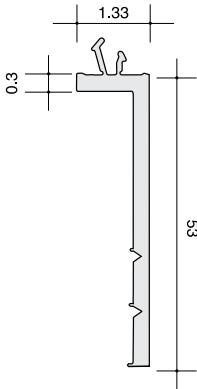

Panel
Art.No.: TF0
Weight: 1140 gr/m

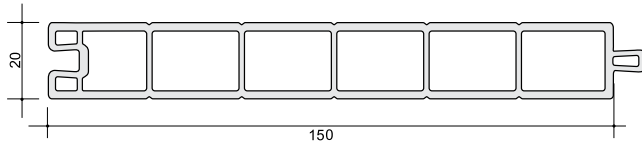

Glazing Bead 34mm
Art.No.: TE6
Weight: 300 gr/m

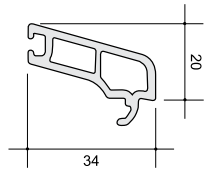

Butia Series

Fixed Slider 60
Systems

Fixed Slider Frame 60
Art.No.: SL01
Weight: 2160 gr/m

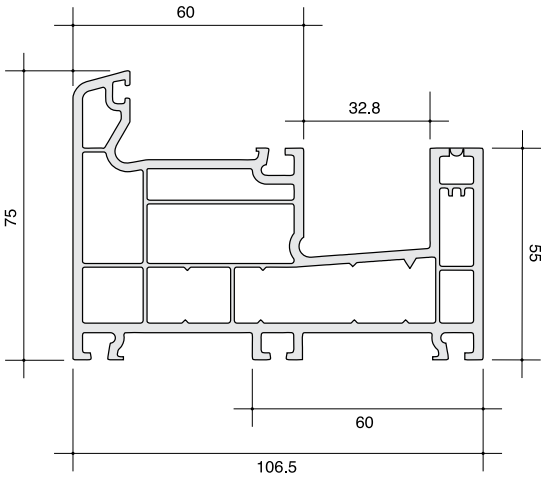

Cover Fixed Slider Frame 60
Art.No.: SL04
Weight: 310 gr/m

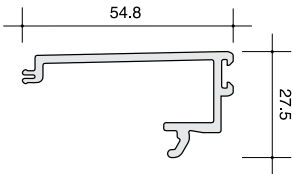

Interlock Sash 60
Art.No.: SL03
Weight: 386 gr/m

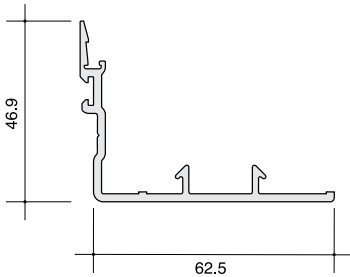

Slider Sash 60
Art.No.: SL02
Weight: 1680 gr/m

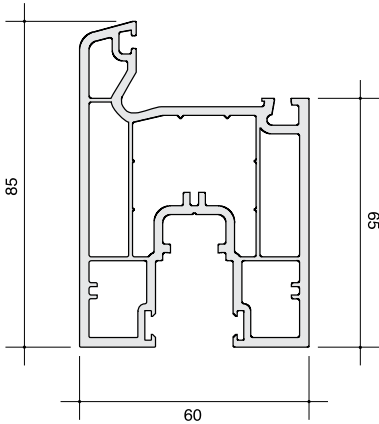

Butia’s A-class door and window uPVC profiles, with the latest global standards, can be used to manufacture uPVC doors and windows in different models and colors, customizable by designers and architects, with a wide variety of sections. Butia’s profiles with 35 sections are used to manufacture different kinds of casement and sliding windows. The company offers hundreds of models and colors using various laminates, uPVC colors, and aluminum coatings for doors and windows.



Rayn Series

Tilt & Turn
Systems

Frame Rayn
Art.No.: RP1

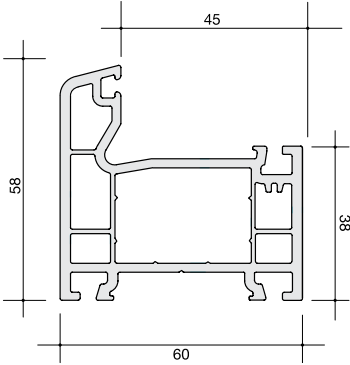

Window Sash Rayn
Art.No.: RP2

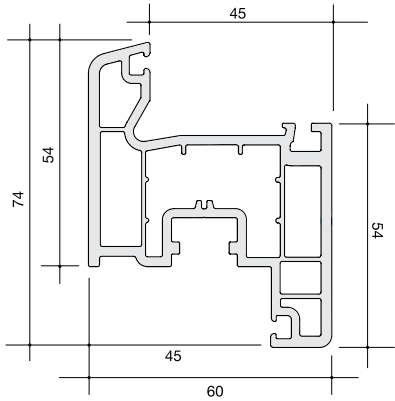

Mullion Rayn
Art.No.: RP3

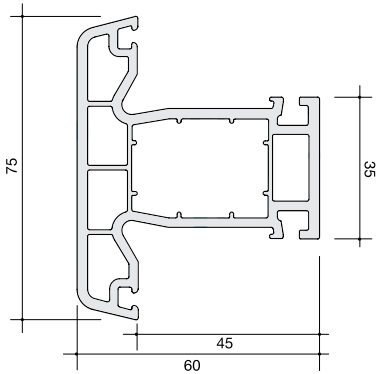

Door Sash Rayn
Art.No.: RP4

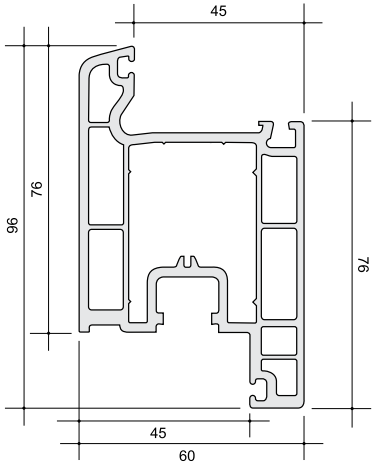

Door Sash 35 Rayn
Art.No.: RP5

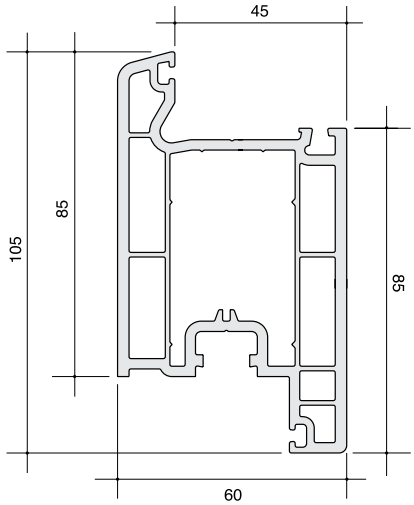

Laminated and color design

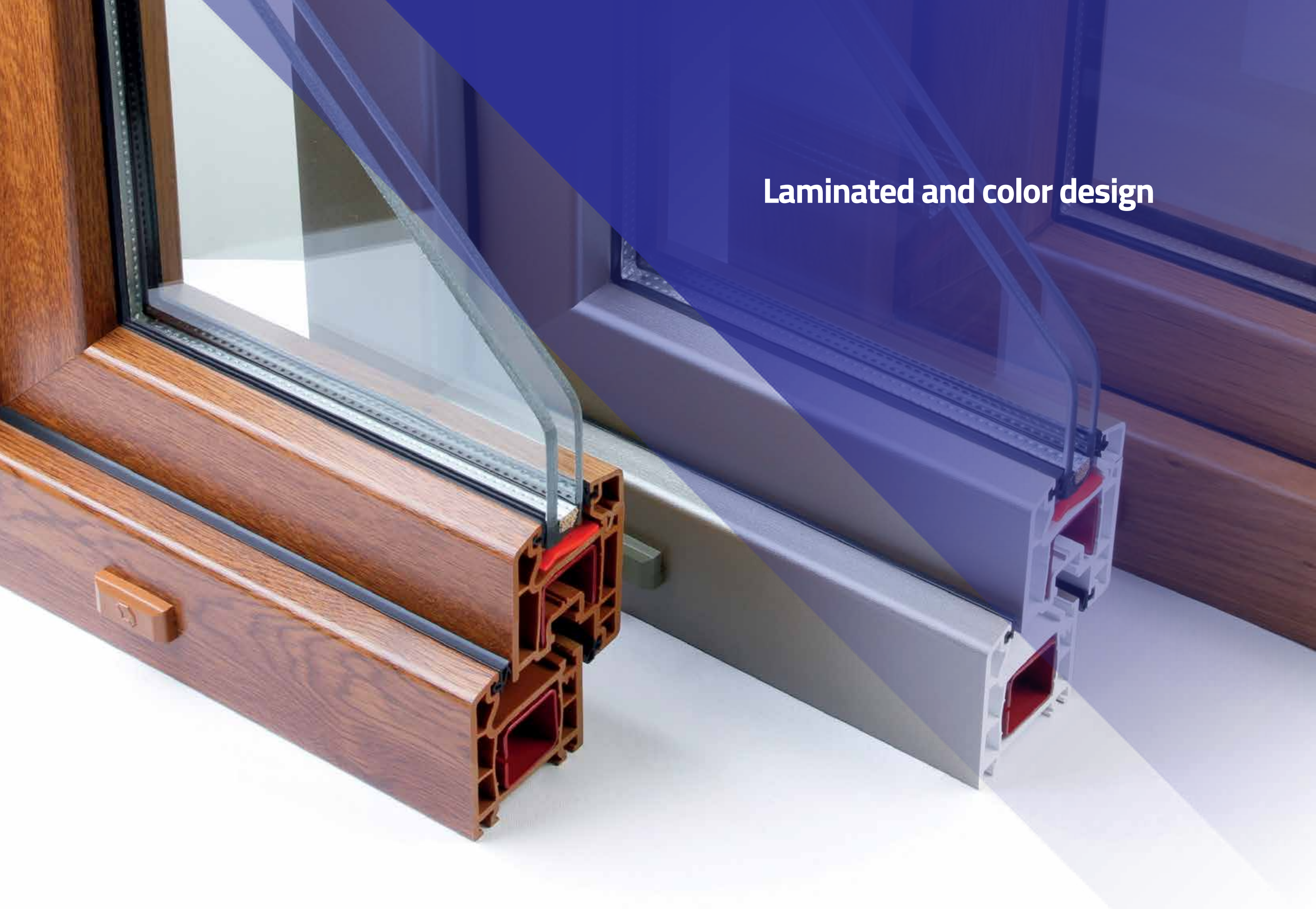



Colored Profile

Considering the diverse demands of architects, designers, and consumers, this company is able to color the profiles and the manufactured double-glazed doors and windows with the highest quality under license of Zobel Company, using uPVC-specific paints made by the Zobel Company of Germany (the most reputable uPVC paint manufacturer).

Laminated Profile

Butia uses the best decorative lamination films of different design and colors, and laminates its profiles in modern machineries.

Butia’s laminated door and window profiles are produced with the finest laminates made by the Renolit Company of Germany, in different models and colors available as one-side laminated doors and both-side (interior and exterior) laminated doors.

They are manufactured by premium raw materials using a sophisticated production line to meet the designers and builders’ needs for laminated double-glazed doors and windows.

Aluminium

Matt

Metalic

Wooden





Champagne
Aluminum cover



Dark Brown
Aluminum cover

Aluskin

Modern residential and industrial architecture eagerly reaches for industrial materials, geometric shapes and sharp colors. Aluskin aluminium clad upvc windows are perfect for such projects. Durable and energy-efficient Alubutia profile guarantees excellent static, thermal and acoustic performance and specially contoured aluminium covers give windows a designer look.

Aluminium covers provide additional layer for windows and work as protection against heat loss and noise. They also protect uPVC profile from atmospheric factors making windows more durable and resistant to deformation and damage.

Modern painting or powder coating technologies allow covering aluminum with any RAL colour.

Advantages of aluminum-cladded

- Retaining the features and benefits of uPVC window insulation while using an aluminum façade for the building
- Improving the mechanical resistance and the stability of doors and windows
- Increasing the rate of thermal insulation and soundproofing due to adding the aluminum cladding to uPVC windows
- Increasing the window's rate of thermal resistance against the sun's dangerous radiations
- Offering the aluminum cladding in different colors
- Saving money on purchase compared to thermally-broken aluminum windows

Double and triple glazed glass





Butia Industry Complex supplies the raw materials required to manufacture multi-glazed glasses from internal and external sources, according to pre-determined specifications and quality, by applying quality control measures. Sheet glass is generally purchased from internal producers and vendors; other materials such as spacers, butyl and polysulfide adhesives, and desiccants are directly imported from Italy.

Multi-glazed glasses are manufactured using fully automatic production lines produced under license in Austria, purchased from LiSEC Company. The line is equipped with an argon gas injection system which works simultaneously with pressing and sticking two glasses together. The primary and secondary seals prevent the ingress of air into the double-glazed glass and stop fogging.



Advantages of using multi-glazed glasses

- It is soundproof and prevents the ingress of dust.
- It is thermally insulated.
- It prevents energy loss.
- Decorations can be set inside the sealed unit (Georgian Bar), thereby remaining clean during the lifespan of the glass.



Decorative Glass



GeorgianBar Glass

Germanella System

Germanella system profiles

- Germanella Shiny Gold
- Germanella Shiny Silver



Victoria System

Victoria system profiles

- Victoria 16x7
- Victoria 25x7



Give a new design to life with decorative Glass

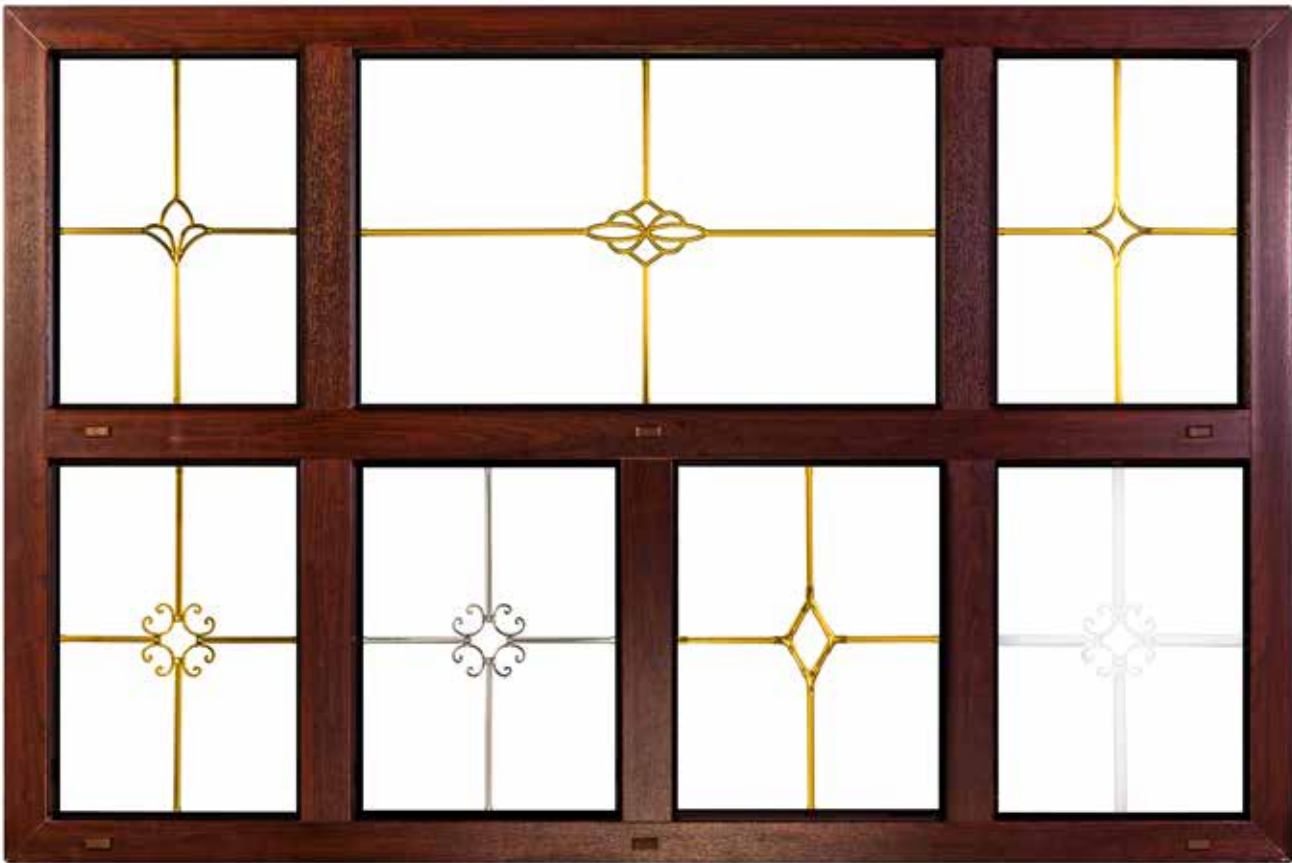



Germanella System

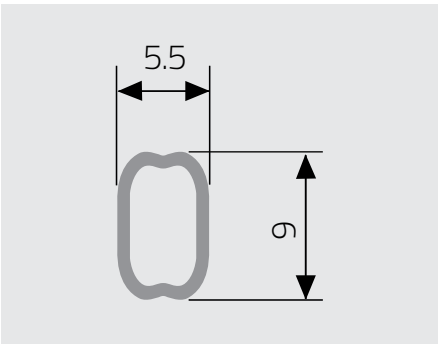
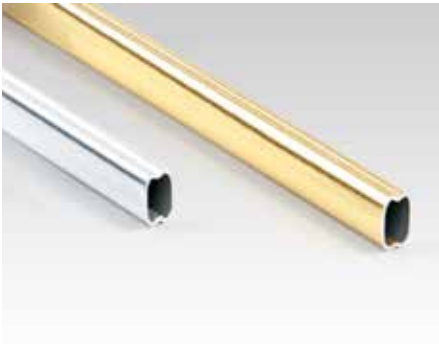

Germanella Profile 5.5*6

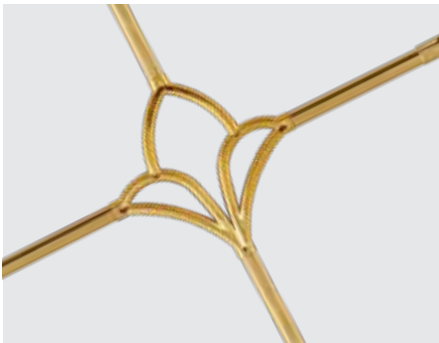

Lili



Flower

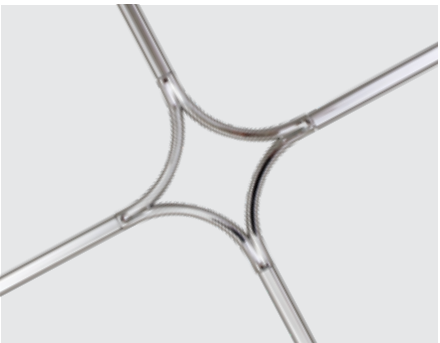
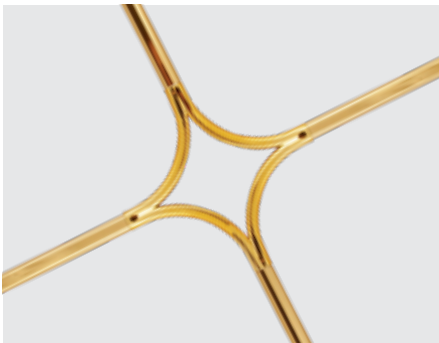

Diamond

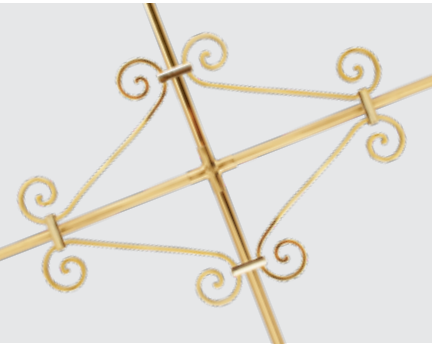

Wrought iron

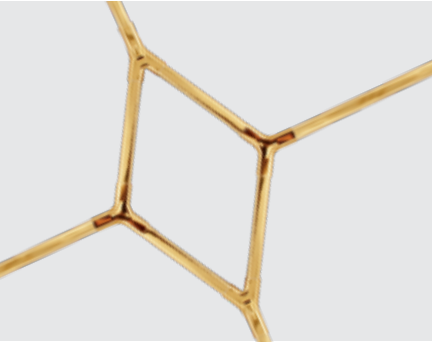

lozenge

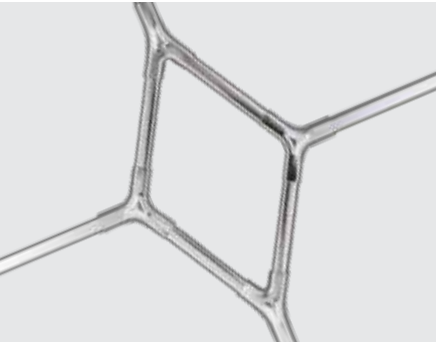

Shamseh



Elegant

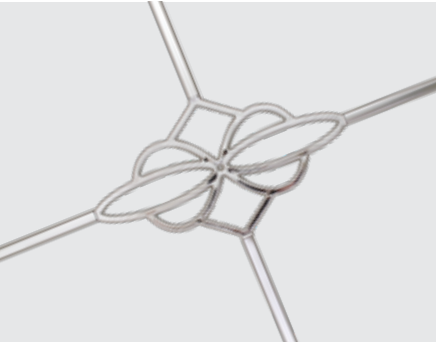

Victoria System

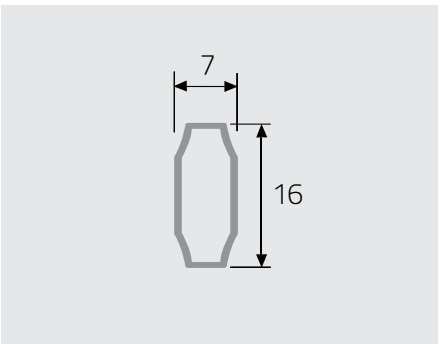

Victoria Profile 16*7

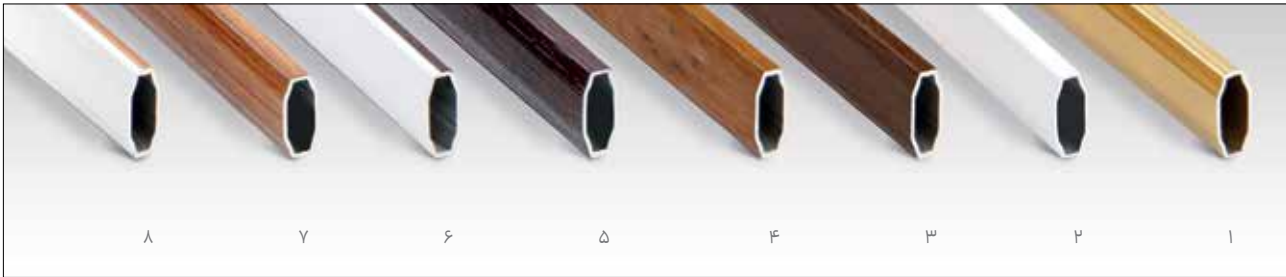

- ١ Gold
- ٢ White
- ٣ Walnut V
- ٤ Winchester XA
- ٥ Black Cherry
- ٦ White / Black Cherry
- ٧ Stripe Douglas
- ٨ White / Stripe Douglas



Victoria White Flower

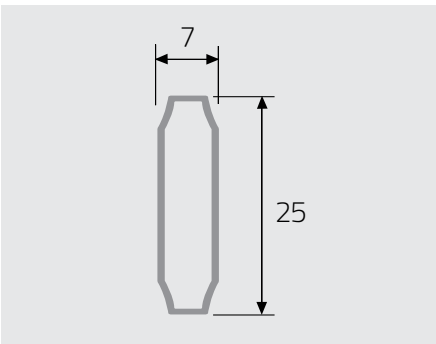
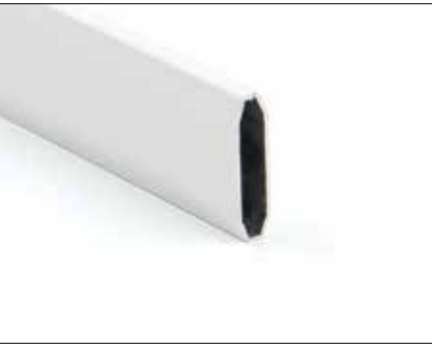

Victoria Profile 25*7



- Gold .1
- White .۲
- Golden Oak .۳
- Walnut V .۴
- Winchester XA .۵
- Black Cherry .۶
- White / Black Cherry .۷
- Stripe Douglas .۸
- White /Stripe Douglas .۹



Victoria Patterns

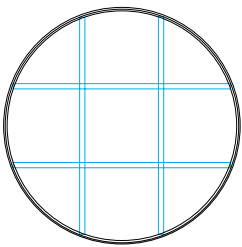

V-25

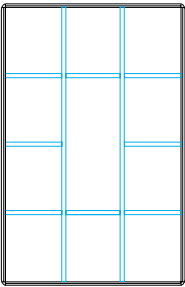

V-13

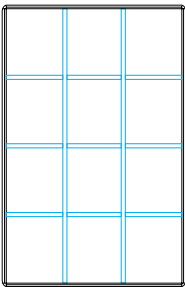

V-07

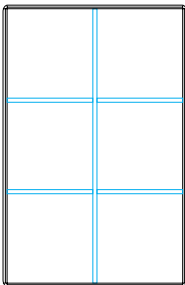

Germanella Patterns

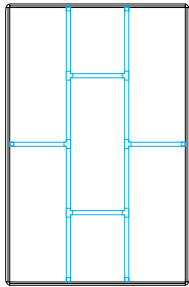

G-11

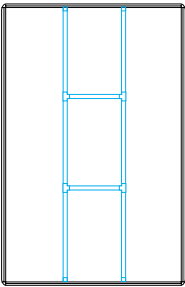

G-09

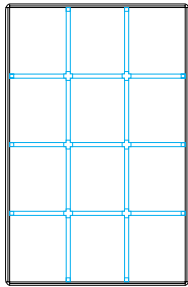

G-07

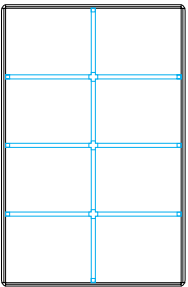

G-05

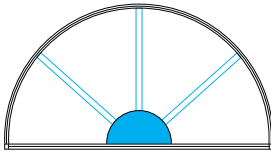

G-23

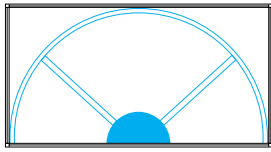

G-19

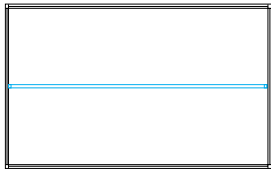

G-15

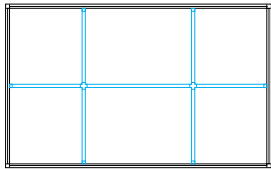

G-17

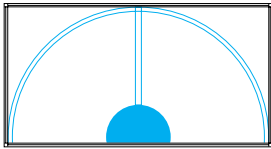

G-18

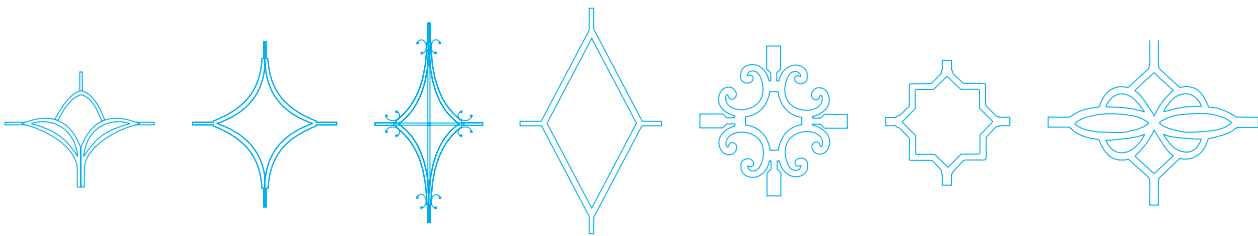

Butia laboratory





Butia laboratory

Simultaneous with the foundation of Butia Industry Complex, the company’s polymer laboratory was launched in 2005 and became operational with the manager’s contribution, exploiting state-of-the-art technologies, modernized equipment, and specialized experienced workforce. After two years of uninterrupted activities, the company acquired the provincial testing laboratory certificate of accreditation.

Thanks to perseverance, qualitative and quantitative laboratory progression, and proper training of experts and employees, the company managed to operate at the international level.



Certification ISO/IEC 17025

acquired the international standard certification ISO/IEC 17025 issued by verified auditors of International Laboratory Accreditation Cooperation (ILAC) in November 2008. entity,

This certification ascertains that testing laboratories are required to prove the application of an all-inclusive control system in their and that they are technically qualified to yield valid, functional results at the international level.



Butia Butia 

Butia [illegible]



©2020, Butia Industry Complex.
All rights reserved.

Butia and Butia logo and logotype are
trademarks of Butia Industry Complex.
registered in Iran and other countries.
For more information about Butia products
visit: www.butia.ir
Printed in Iran, December 2020



Contact us

021-430 85
www.butia.ir
e-mail: info@butia.ir



Follow us

Instagram:
[Butia.ir](https://www.instagram.com/butia.ir)